

## Suggested Set Design

The stage is set out in three sections:

- CENTRE: The main staffroom with old sofa, chair(s), coffee table, sink / fridge (opening window behind), notice board with old messages and "N.U.T" section.
- APRON STAGE RIGHT: The corridor outside the school office. This could be a flat showing a window to the office and a display board for children's work.
- APRON STAGE LEFT: A mock classroom. This could be a simple teacher's desk and chair with a white or chalk board behind. Written on the board could be things like "Lern spelings for tomorow" or children's board duster graffiti "I 8 SKOOL" with teacher's writing after it "So do I!"

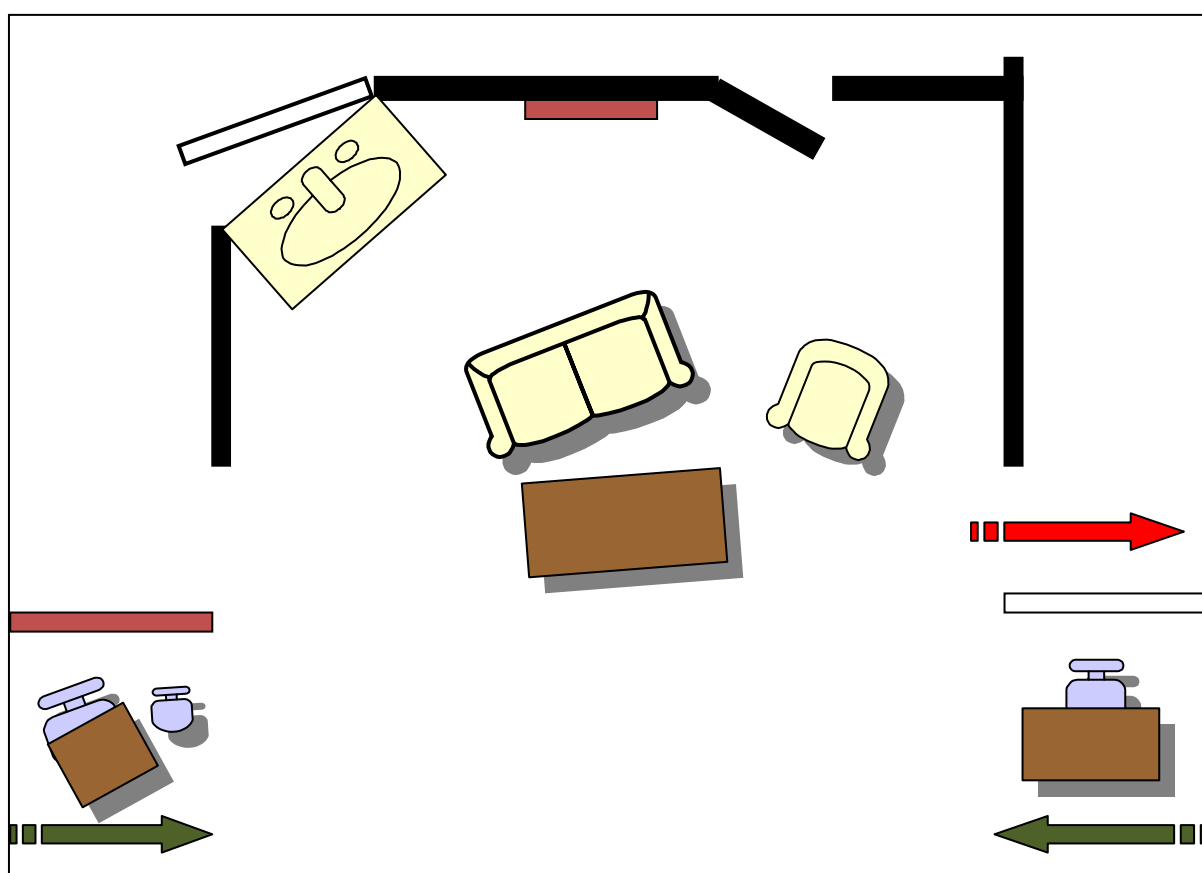

### Furniture

- 1 coffee table littered with mugs, unopened mail, exercise books etc
- 1 notice board about to fall off the wall
- 1 worn-out sofa and assortment of old plastic chairs
- 1 Formica kitchen cupboard with worktop and sink (unplumbed)
- 1 dirty old fridge
- 2 office desk plus normal-sized chair or stool and tiny infant chair
- 1 wall display of childrens' work including an A4 sheet decorated with multi-coloured felt-tip borders